



P1D-X Pneumatic Cylinders

According to
ISO 15552



High and Low Temperature Cylinders

P1D-X series contains cylinder versions for high and low temperature. These versions have material and sealing systems specially designed for their particular temperature ranges. End covers and pistons are made entirely from metal, to give optimum function at **high** or **low** temperature in combination with seals made from specially tested materials and special grease.

- Bore sizes 32-125 mm.
- Double acting.
- Stainless steel piston rod.
- Robust and corrosion resistant.
- Adjustable air cushioning.
- Retained stainless steel cushioning screws.
- Wide range of mountings and drop-in sensors

P1D-X High Temperature Cylinders

All seals in the high temperature version of P1D-X are developed and validated for continuous operation up to +150° C. The combination of the seal geometry and the FKM (DIN ISO 16299) material ensures reliable and long service life. Certain restrictions apply when choosing sensors due to the temperature range. High temperature cylinders have no magnetic piston and cannot be fitted with sensors (the magnetic field strength in high temperatures is too low to ensure correct reliable sensor function).

- Conforms to ISO 15552.
- Bore 32-125 mm.
- Double acting.
- Stainless steel piston rod.
- Adjustable air cushioning.
- Wide range of mountings.



Operating information

Working pressure:	Max 10 bar
Working temperature:	
High temp. version	-10°C to +150°C

For more information see www.parker.com/euro_pneumatic

P1D-X - High temperature (no magnetic)

Ø32mm - (G¹/₈)

Stroke mm	Order code
25	P1D-X032MF-0025
50	P1D-X032MF-0050
80	P1D-X032MF-0080
100	P1D-X032MF-0100
125	P1D-X032MF-0125
160	P1D-X032MF-0160
200	P1D-X032MF-0200
250	P1D-X032MF-0250
320	P1D-X032MF-0320
400	P1D-X032MF-0400
500	P1D-X032MF-0500

Ø63mm - (G³/₈)

Stroke mm	Order code
25	P1D-X063MF-0025
50	P1D-X063MF-0050
80	P1D-X063MF-0080
100	P1D-X063MF-0100
125	P1D-X063MF-0125
160	P1D-X063MF-0160
200	P1D-X063MF-0200
250	P1D-X063MF-0250
320	P1D-X063MF-0320
400	P1D-X063MF-0400
500	P1D-X063MF-0500

Ø100mm - (G¹/₂)

Stroke mm	Order code
25	P1D-X100MF-0025
50	P1D-X100MF-0050
80	P1D-X100MF-0080
100	P1D-X100MF-0100
125	P1D-X100MF-0125
160	P1D-X100MF-0160
200	P1D-X100MF-0200
250	P1D-X100MF-0250
320	P1D-X100MF-0320
400	P1D-X100MF-0400
500	P1D-X100MF-0500

Ø40mm - (G¹/₄)

Stroke mm	Order code
25	P1D-X040MF-0025
50	P1D-X040MF-0050
80	P1D-X040MF-0080
100	P1D-X040MF-0100
125	P1D-X040MF-0125
160	P1D-X040MF-0160
200	P1D-X040MF-0200
250	P1D-X040MF-0250
320	P1D-X040MF-0320
400	P1D-X040MF-0400
500	P1D-X040MF-0500

Ø80mm - (G³/₈)

Stroke mm	Order code
25	P1D-X080MF-0025
50	P1D-X080MF-0050
80	P1D-X080MF-0080
100	P1D-X080MF-0100
125	P1D-X080MF-0125
160	P1D-X080MF-0160
200	P1D-X080MF-0200
250	P1D-X080MF-0250
320	P1D-X080MF-0320
400	P1D-X080MF-0400
500	P1D-X080MF-0500

Ø125mm - (G¹/₂)

Stroke mm	Order code
25	P1D-X125MF-0025
50	P1D-X125MF-0050
80	P1D-X125MF-0080
100	P1D-X125MF-0100
125	P1D-X125MF-0125
160	P1D-X125MF-0160
200	P1D-X125MF-0200
250	P1D-X125MF-0250
320	P1D-X125MF-0320
400	P1D-X125MF-0400
500	P1D-X125MF-0500

Ø50mm - (G¹/₄)

Stroke mm	Order code
25	P1D-X050MF-0025
50	P1D-X050MF-0050
80	P1D-X050MF-0080
100	P1D-X050MF-0100
125	P1D-X050MF-0125
160	P1D-X050MF-0160
200	P1D-X050MF-0200
250	P1D-X050MF-0250
320	P1D-X050MF-0320
400	P1D-X050MF-0400
500	P1D-X050MF-0500

The cylinders are supplied complete with a zinc plated steel piston rod nut.

P1D-X Low Temperature Cylinders

All seals in the low temperature version of P1D-X are developed and validated for continuous operation down to -40° C. Polyurethane PUR seal technology and specifically formulated grease support performance and reliability for low temperature applications. As standard supplied with a magnetic ring in the piston for proximity sensing but please note that the sensors are normally specified for full performance to -25° C only.



- Conforms to ISO 15552.
- Bore 32-125 mm.
- Double acting.
- Stainless steel piston rod.
- Adjustable air cushioning.
- Wide range of mountings and drop-in sensors.

Operating information

Working pressure: Max 10 bar
 Working temperature:
 Low temp. version **-40°C to +80°C**

P1D-X - Low temperature

Ø32mm - (G¹/₈)

Stroke mm	Order code
25	P1D-X032ML-0025
50	P1D-X032ML-0050
80	P1D-X032ML-0080
100	P1D-X032ML-0100
125	P1D-X032ML-0125
160	P1D-X032ML-0160
200	P1D-X032ML-0200
250	P1D-X032ML-0250
320	P1D-X032ML-0320
400	P1D-X032ML-0400
500	P1D-X032ML-0500

Ø63mm - (G³/₈)

Stroke mm	Order code
25	P1D-X063ML-0025
50	P1D-X063ML-0050
80	P1D-X063ML-0080
100	P1D-X063ML-0100
125	P1D-X063ML-0125
160	P1D-X063ML-0160
200	P1D-X063ML-0200
250	P1D-X063ML-0250
320	P1D-X063ML-0320
400	P1D-X063ML-0400
500	P1D-X063ML-0500

Ø100mm - (G¹/₂)

Stroke mm	Order code
25	P1D-X100ML-0025
50	P1D-X100ML-0050
80	P1D-X100ML-0080
100	P1D-X100ML-0100
125	P1D-X100ML-0125
160	P1D-X100ML-0160
200	P1D-X100ML-0200
250	P1D-X100ML-0250
320	P1D-X100ML-0320
400	P1D-X100ML-0400
500	P1D-X100ML-0500

Ø40mm - (G¹/₄)

Stroke mm	Order code
25	P1D-X040ML-0025
50	P1D-X040ML-0050
80	P1D-X040ML-0080
100	P1D-X040ML-0100
125	P1D-X040ML-0125
160	P1D-X040ML-0160
200	P1D-X040ML-0200
250	P1D-X040ML-0250
320	P1D-X040ML-0320
400	P1D-X040ML-0400
500	P1D-X040ML-0500

Ø80mm - (G³/₄)

Stroke mm	Order code
25	P1D-X080ML-0025
50	P1D-X080ML-0050
80	P1D-X080ML-0080
100	P1D-X080ML-0100
125	P1D-X080ML-0125
160	P1D-X080ML-0160
200	P1D-X080ML-0200
250	P1D-X080ML-0250
320	P1D-X080ML-0320
400	P1D-X080ML-0400
500	P1D-X080ML-0500

Ø125mm - (G¹/₂)

Stroke mm	Order code
25	P1D-X125ML-0025
50	P1D-X125ML-0050
80	P1D-X125ML-0080
100	P1D-X125ML-0100
125	P1D-X125ML-0125
160	P1D-X125ML-0160
200	P1D-X125ML-0200
250	P1D-X125ML-0250
320	P1D-X125ML-0320
400	P1D-X125ML-0400
500	P1D-X125ML-0500

Ø50mm - (G¹/₄)

Stroke mm	Order code
25	P1D-X050ML-0025
50	P1D-X050ML-0050
80	P1D-X050ML-0080
100	P1D-X050ML-0100
125	P1D-X050ML-0125
160	P1D-X050ML-0160
200	P1D-X050ML-0200
250	P1D-X050ML-0250
320	P1D-X050ML-0320
400	P1D-X050ML-0400
500	P1D-X050ML-0500

The cylinders are supplied complete with a zinc plated steel piston rod nut.

P1D-X Metallic Scraper Cylinders

All seals in the metallic version of P1D-X are developed and validated for continuous operation down to -30°C . Polyurethane PUR seal technology and specifically formulated grease support performance and reliability for external applications. As standard supplied with a magnetic ring in the piston for proximity sensing but please note that the sensors are normally specified for full performance to -25°C only.



- Conforms to ISO 15552.
- Bore 32-125 mm.
- Double acting.
- Chromed plated steel piston rod.
- Adjustable air cushioning.
- Wide range of mountings and drop-in sensors.

Operating information

Working pressure:	Max 10 bar
Working temperature:	
Low temp. version	-30°C to $+80^{\circ}\text{C}$

For more information see www.parker.com/euro_pneumatic

P1D-X - Low temperature, Metallic scraper

Ø32mm - (G^{1/8})

Stroke mm	Order code
25	P1D-X032QK-0025
50	P1D-X032QK-0050
80	P1D-X032QK-0080
100	P1D-X032QK-0100
125	P1D-X032QK-0125
160	P1D-X032QK-0160
200	P1D-X032QK-0200
250	P1D-X032QK-0250
320	P1D-X032QK-0320
400	P1D-X032QK-0400
500	P1D-X032QK-0500

Ø63mm - (G^{3/8})

Stroke mm	Order code
25	P1D-X063QK-0025
50	P1D-X063QK-0050
80	P1D-X063QK-0080
100	P1D-X063QK-0100
125	P1D-X063QK-0125
160	P1D-X063QK-0160
200	P1D-X063QK-0200
250	P1D-X063QK-0250
320	P1D-X063QK-0320
400	P1D-X063QK-0400
500	P1D-X063QK-0500

Ø100mm - (G^{1/2})

Stroke mm	Order code
25	P1D-X100QK-0025
50	P1D-X100QK-0050
80	P1D-X100QK-0080
100	P1D-X100QK-0100
125	P1D-X100QK-0125
160	P1D-X100QK-0160
200	P1D-X100QK-0200
250	P1D-X100QK-0250
320	P1D-X100QK-0320
400	P1D-X100QK-0400
500	P1D-X100QK-0500

Ø40mm - (G^{1/4})

Stroke mm	Order code
25	P1D-X040QK-0025
50	P1D-X040QK-0050
80	P1D-X040QK-0080
100	P1D-X040QK-0100
125	P1D-X040QK-0125
160	P1D-X040QK-0160
200	P1D-X040QK-0200
250	P1D-X040QK-0250
320	P1D-X040QK-0320
400	P1D-X040QK-0400
500	P1D-X040QK-0500

Ø80mm - (G^{3/8})

Stroke mm	Order code
25	P1D-X080QK-0025
50	P1D-X080QK-0050
80	P1D-X080QK-0080
100	P1D-X080QK-0100
125	P1D-X080QK-0125
160	P1D-X080QK-0160
200	P1D-X080QK-0200
250	P1D-X080QK-0250
320	P1D-X080QK-0320
400	P1D-X080QK-0400
500	P1D-X080QK-0500

Ø125mm - (G^{1/2})

Stroke mm	Order code
25	P1D-X125QK-0025
50	P1D-X125QK-0050
80	P1D-X125QK-0080
100	P1D-X125QK-0100
125	P1D-X125QK-0125
160	P1D-X125QK-0160
200	P1D-X125QK-0200
250	P1D-X125QK-0250
320	P1D-X125QK-0320
400	P1D-X125QK-0400
500	P1D-X125QK-0500

Ø50mm - (G^{1/4})

Stroke mm	Order code
25	P1D-X050QK-0025
50	P1D-X050QK-0050
80	P1D-X050QK-0080
100	P1D-X050QK-0100
125	P1D-X050QK-0125
160	P1D-X050QK-0160
200	P1D-X050QK-0200
250	P1D-X050QK-0250
320	P1D-X050QK-0320
400	P1D-X050QK-0400
500	P1D-X050QK-0500

The cylinders are supplied complete with a zinc plated steel piston rod nut.

P1D-X Series

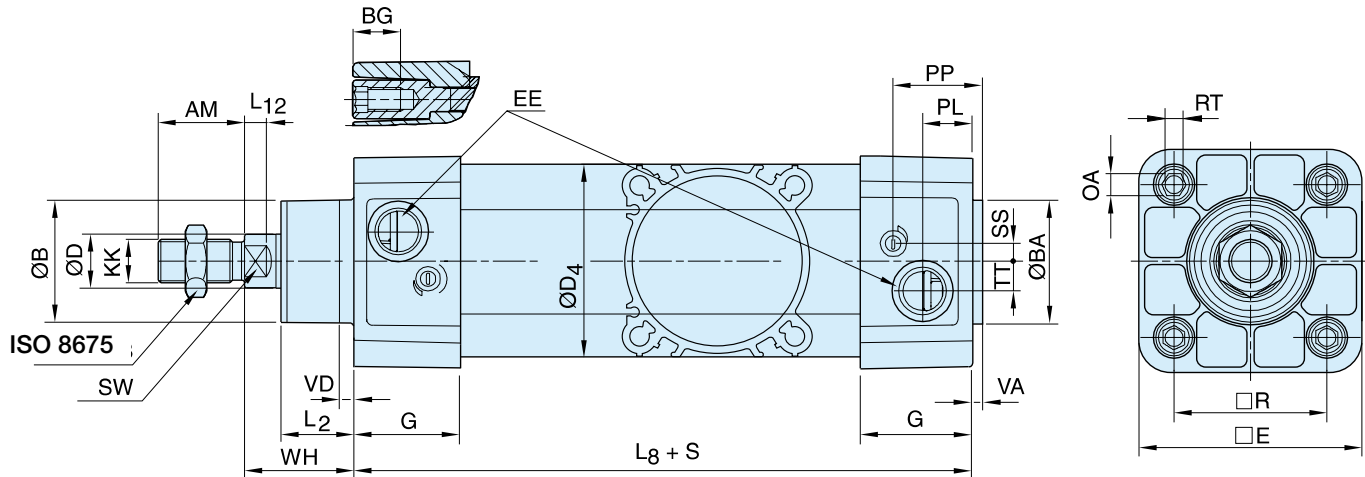

Dimensions

Cylinder bore mm	AM mm	B mm	BA mm	BG mm	D mm	D4 mm	E mm	EE mm	G mm	KK	L2 mm	L8 mm	L12 mm
32	22	30	30	16	12	45,0	48,0	G1/8	28,5	M10x1,25	16,8	94	6,0
40	24	35	35	16	16	52,0	53,5	G1/4	33,0	M12x1,25	19,0	105	6,5
50	32	40	40	16	20	60,7	65,2	G1/4	33,5	M16x1,5	24,0	106	8,0
63	32	45	45	16	20	71,5	75,5	G3/8	39,5	M16x1,5	24,3	121	8,0
80	40	45	45	17	25	86,7	95,0	G3/8	39,5	M20x1,5	30,0	128	10,0
100	40	55	55	17	25	106,7	114,0	G1/2	44,5	M20x1,5	34,0	138	14,0
125	54	60	60	20	32	134,0	139,0	G1/2	51,0	M27x2	45,0	160	18,0

Cylinder bore mm	OA mm	PL mm	PP mm	R mm	RT mm	SS mm	SW mm	TT mm	VA mm	VD mm	WH mm
32	6,0	14,0	24,2	32,5	M6	5,5	10	4,2	3,5	4,5	26
40	6,0	16,0	27,5	38,0	M6	8,0	13	5,5	3,5	4,5	30
50	8,0	14,0	29,3	46,5	M8	9,0	17	7,5	3,5	4,5	37
63	8,0	16,6	30,8	56,5	M8	6,5	17	10,0	3,5	4,5	37
80	6,0	16,8	33,5	72,0	M10	0	22	11,5	3,5	4,5	46
100	6,0	20,5	37,5	89,0	M10	0	22	14,5	3,5	4,5	51
125	8,0	23,3	45,8	110,0	M12	0	27	15,0	5,5	6,5	65

S=Stroke

Tolerances

Cylinder bore mm	B	BA	L ₈ mm	L ₉ mm	R mm	Stroke tolerance up to stroke 500 mm	Stroke tolerance for stroke over 500 mm
32	d11	d11	±0,4	±2	±0,5	+0,3/+2,0	+0,3/+3,0
40	d11	d11	±0,7	±2	±0,5	+0,3/+2,0	+0,3/+3,0
50	d11	d11	±0,7	±2	±0,6	+0,3/+2,0	+0,3/+3,0
63	d11	d11	±0,8	±2	±0,7	+0,3/+2,0	+0,3/+3,0
80	d11	d11	±0,8	±3	±0,7	+0,3/+2,0	+0,3/+3,0
100	d11	d11	±1,0	±3	±0,7	+0,3/+2,0	+0,3/+3,0
125	d11	d11	±1,0	±3	±1,1	+0,3/+2,0	+0,3/+3,0

For mountings refer to page 29.